

Spare parts list

auma[®]
AUMA MATIC
AM 01.1 – AM 02.1

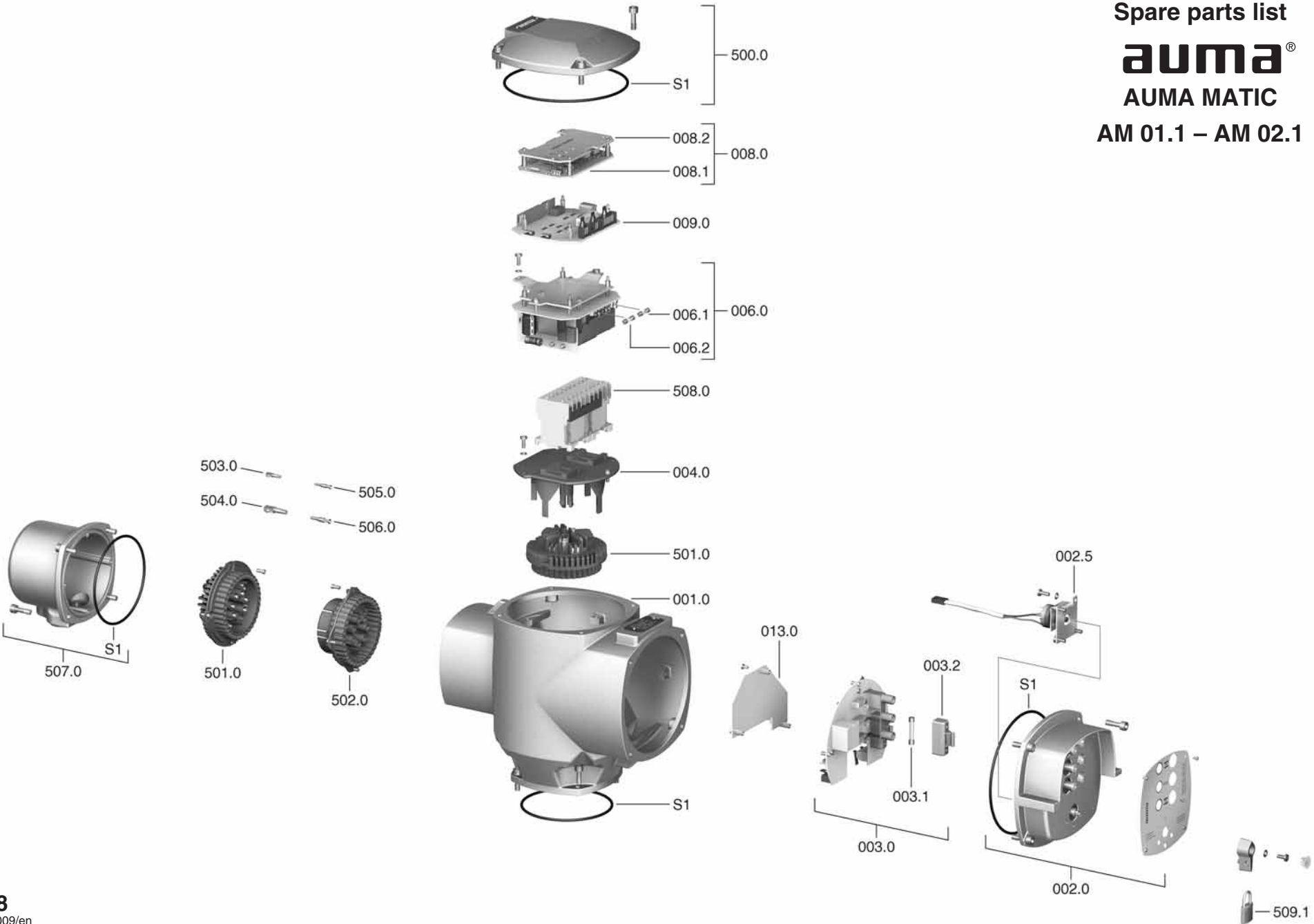

Please state type and commission no. of the device (see name plate) when ordering spare parts. Only original AUMA spare parts should be used. Failure to use original spare parts voids the warranty and exempts AUMA from any liability. Delivered spare parts may slightly vary from the representation.

No.	Designation	Type
001.0	Housing	
002.0	Local controls	Sub-assembly
002.5	Selector switch	Sub-assembly
003.0	Local controls board	Sub-assembly
003.1	Primary fuse	
003.2	Fuse cover	
004.0	Carrier for contactors	
006.0	Power supply including mounting plate	Sub-assembly
006.1	Secondary fuse F3	
006.2	Secondary fuse F4	
008.0	Interface board	Sub-assembly
008.1	Interface board	
008.2	Cover plate for interface board	
009.0	Logic board	Sub-assembly
013.0	Adapter board	Sub-assembly
500.0	Cover	Sub-assembly
501.0	Socket carrier (complete with sockets)	Sub-assembly
502.0	Pin carrier without pins	Sub-assembly
503.0	Socket for controls	Sub-assembly
504.0	Socket for motor	Sub-assembly
505.0	Pin for controls	Sub-assembly
506.0	Pin for motor	Sub-assembly
507.0	Plug cover	Sub-assembly
508.0	Switchgear	Sub-assembly
509.1	Padlock	
S1	Seal kit	Set

We reserve the right to alter data according to improvements made. Previous documents become invalid with the issue of this document.