

Spare parts list
auma[®]
 Part-turn actuators
 SQ 05.2 - SQ 14.2

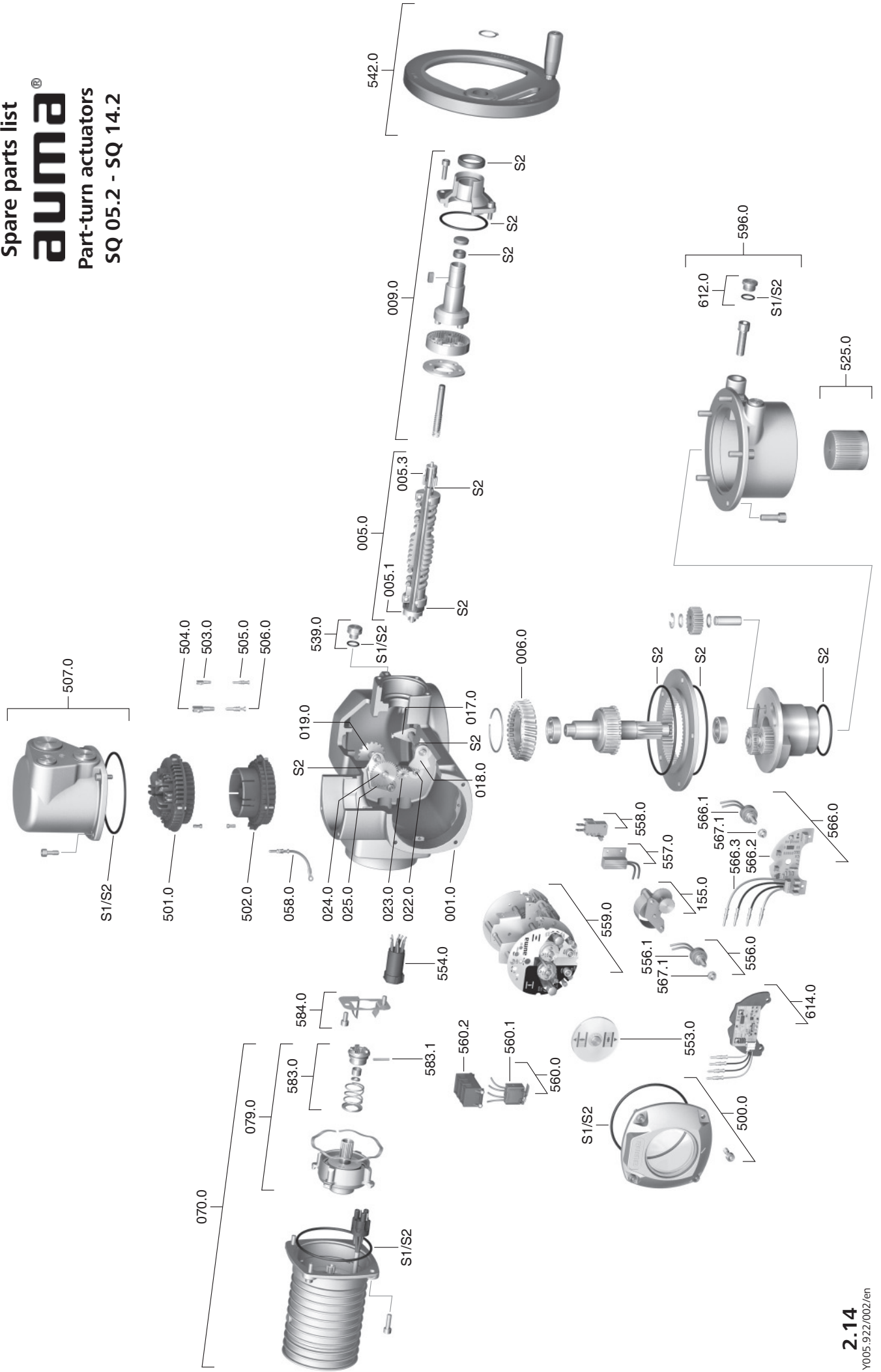

Spare parts list part-turn actuators

Please state type and order no. of the device (see name plate) when ordering spare parts. Only original AUMA spare parts should be used. Failure to use original spare parts voids the warranty and exempts AUMA from any liability. Delivered spare parts may slightly vary from the representation.

Ref. No.	Designation	Type	Ref. No.	Designation	Type
001.0	Housing	Sub-assembly	542.0	Handwheel with ball handle	
005.0	Drive shaft	Sub-assembly	553.0	Mechanical position indicator	Sub-assembly
005.1	Motor coupling	Sub-assembly	554.0	Socket carrier for motor plug/socket connector with cable harness	Sub-assembly
005.3	Manual drive coupling		556.0	Potentiometer as position transmitter	Sub-assembly
006.0	Worm wheel	Sub-assembly	556.1	Potentiometer without slip clutch	Sub-assembly
009.0	Manual gearing	Sub-assembly	557.0	Heater	Sub-assembly
017.0	Torque lever		558.0	Blinker transmitter including pins at wires (without impulse disc and insulation plate)	Sub-assembly
018.0	Gear segment	Sub-assembly	559.0	Control unit with torque switching heads and switches	Sub-assembly
019.0	Crown wheel		559.0	Control unit with magnetic limit and torque transmitter (MWG) for Non-intrusive version in combination with AUMATIC integral controls	Sub-assembly
022.0	Drive pinion II for torque switching	Sub-assembly	560.0	Switch stack for direction OPEN	Sub-assembly
023.0	Output drive wheel for limit switching	Sub-assembly	560.0	Switch stack for direction CLOSE	Sub-assembly
024.0	Drive wheel for limit switching	Sub-assembly	560.1	Switch for limit/torque switching	Sub-assembly
025.0	Locking plate	Sub-assembly	560.2	Switch case	
058.0	Wire for protective earth	Sub-assembly	566.0	Position transmitter RWG	Sub-assembly
070.0	Motor (VD motor incl. ref.no. 079.0)	Sub-assembly	566.1	Potentiometer for RWG without slip clutch	Sub-assembly
079.0	Planetary gear for motor drive (SQ 05.2 - 14.2 for VD motor)	Sub-assembly	566.2	Position transmitter board for RWG	Sub-assembly
155.0	Reduction gearing	Sub-assembly	566.3	Wire harness for RWG	Sub-assembly
500.0	Cover	Sub-assembly	567.1	Slip clutch for potentiometer	Sub-assembly
501.0	Socket carrier (complete with sockets)	Sub-assembly	583.0	Motor coupling on motor shaft	Sub-assembly
502.0	Pin carrier without pins	Sub-assembly	583.1	Pin for motor coupling	Sub-assembly
503.0	Socket for controls	Sub-assembly	584.0	Retaining spring for motor coupling	
504.0	Socket for motor		596.0	Output drive flange with end stop	Sub-assembly
505.0	Pin for controls	Sub-assembly	612.0	Screw plug for end stop	Sub-assembly
506.0	Pin for motor	Sub-assembly	614.0	Position transmitter EWG	Sub-assembly
507.0	Cover for electrical connection	Sub-assembly	S1	Seal kit, small	Set
525.0	Coupling	Sub-assembly	S2	Seal kit, large	Set
539.0	Screw plug	Sub-assembly			